

# STAINLESS METALFLOW-CSMA

CSMA is a metal filter made by sintering several layers of meshes with different mesh sizes and sintering at high temperature and high pressure. It has excellent durability and removal efficiency and provides stable process operation.



### Features

- Can be used in harsh environments such as high temperature and high pressure
- Wide filtration grade
- Excellent durability because of multi-ply mesh sintering
- 100% stainless steel

### Applications

High temperature, high pressure gas filtration, High viscosity polymer filtration, Petrochemical industry, Water treatment, Food and beverage industry

### Structure

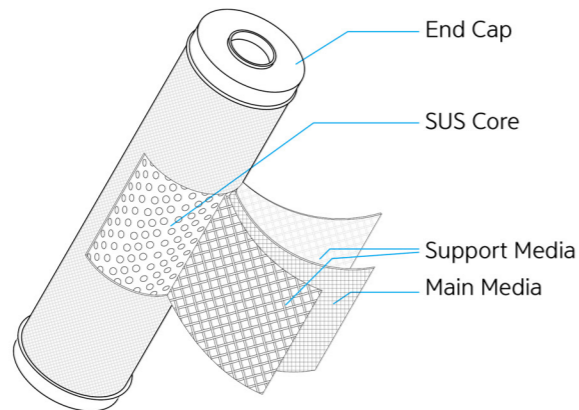

### Specifications

Dimensions	Length (mm)	125/ 250 / 500 / 750 / 1000	
	Inner Diameter (mm)	30	
	Outer Diameter (mm)	65	
Materials	Main Media	SUS304 / SUS316L	
	Support Media	SUS304 / SUS316L	
	Core & Out cage	SUS304 / SUS316L	
	Seal	Gasket	Silicone / EPDM / Viton / PTFE
O-ring		Silicone / EPDM / Viton / FEP Encapsulated	
Operating Conditions	Max. Temperature(°C)	538(1000°F) for continuous of 648(1,200°F) intermittently	* Based on D.I Water
	Max. ΔP(Kgf/cm²)	7.0	
Clean Ability	Standard Methods	Steam back pulsing	
		High pressure jet water	
		Ultrasonic	
		Chemical processing	
		High temperature hydrogen furnace heat treating	

### Part Number Identification

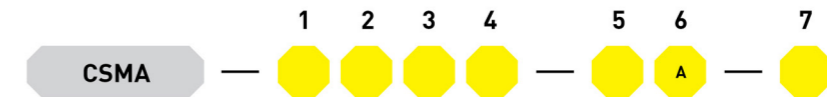

①	②	③	④	⑤	⑥	⑦
End Style	Media	Type of Cartridge	Materials of Seal	Length of Filter	Grade	Mesh Size
1: DOE	S: SUS304	T: Standard	S: Silicone	1: 250mm	A: Absolute	#40 ~ #2000
3: 222/Flat	L: SUS316L	P: Pleated	E: EPDM	2: 500mm		
7: 226/Fin			V: Viton	3: 750mm		
T: Thread (Standard Consultation Required)			F: FEP Encapsulated	4: 1000mm		
			T: PTFE	6: 125mm		
				ETC.		

### Adaptor Style

